

TJ-225

Smart Wi-Fi Thermostat with Nightlight

User Manual

vīne®



Electronic manual and installation video

1. This user manual only includes installation and simple setup instructions. For the more detailed operating instructions and user guide, scan the QR code.
2. Watch installation video by scanning the QR code.



Electronic manual



Installation Video

WE ARE HERE TO HELP, 24/7 !

WEBSITE: www.vineconnected.com

EMAIL: support@vineconnected.com

HOTLINE: 1-800-264-3457(09:00am~05:00pm MON~FRI PST)

Vine App Setup

1. To download the "Vine Smart Control" app, scan the QR code or search "Vine Smart Control" in the Apple App Store or Google Play Store.

iOS/Android

App Download



2. Open the "Vine Smart Control" app. If you already have an account, tap Sign In. To create a new account, tap Sign Up.







Note: You must create your own Vine account to use third-party services and products. These will not work with a guest account. With a Vine account, you can also allow your family and friends to control your smart thermostat.

3. Tap + and select your smart thermostat.

4. Follow the in-app instructions to set up your smart thermostat.

Note: You can change the name and icon at any time by going to the smart thermostat screen and tapping. You can use the Vine app to connect your smart thermostat to Amazon Alexa or Google Assistant.

Vine Thermostat - A Smart Choice for Smart Life!

-  Vine Wi-Fi Thermostat
-  Screw sets
-  Flathead screwdriver
-  Wire labels
-  Jumper wire
-  User Manual



You may also need these tools:



Phillips screwdriver



Level



Pencil



Home Wi-Fi Password

Compatibility Section

- Conventional (2H/2C)
- Heat Pump (3H/2C) incl. 1-stage Auxiliary heat or Emergency Heat
- Gas, Oil, Electric
- Dual Fuel support

Require C-Wire to power the thermostat (24V-AC)

Note: If you're uncertain about your wiring, get Professional help or contact with 1-800-264-3457

Incompatible wiring and voltage

Please check the wall plate of your old thermostat to see if there's any indication as follows:

- **Does not work with electric baseboard heat (110VAC~240VAC)**
- **Does not work with millivolt systems**
- **Does not support S terminals for indoors and outdoors sensors.**

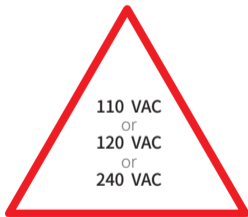
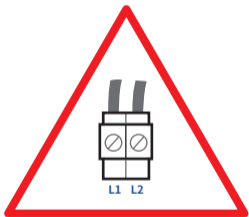

NOTE : If you are unsure, please contact a professional or or call 1-800-264-3457

Create an account

When the app is ready, we need to move to next step to create an account, which is important for full functioning and remote access of the thermostat. Create the account with a valid email address and remember well the password as the thermostat will be linked to this email address once registered.



Installation

This TJ-225 thermostat is designed to work on most 24V-AC low voltage heating and cooling systems such as gas and oil furnaces, heat pumps, and single or dual-stage systems.

Step 1 Switch off power

IMPORTANT as this protects you from blowing a fuse in your equipment. To make sure the power is off, change the temperature with your current thermostat and wait for at least 5 minutes to be sure that the system is OFF.



Breaker Box

or



Switch

Step 2 Check that your system is off

Confirm your system is off by turning on your heat (during winter) or your AC (during summer). Wait a few minutes—you should not feel air coming from your vents.

NOTE : If you have a digital thermostat that has a blank display, skip this step.

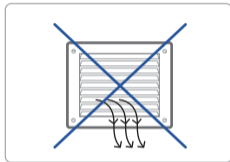
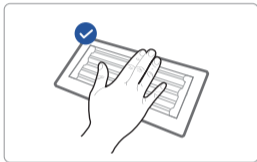

Step 3 Remove your old thermostat from the wall plate

Most thermostats allow you to remove the main unit and provide access to a wall plate which holds the wiring terminals, you can take off the thermostat by grasping and gently pulling. Some thermostats may have screws, buttons, or clasps.

NOTE : DO NOT remove any wires from your old thermostat in this step.

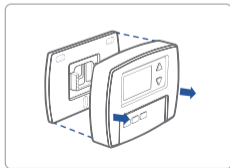

Step 4 **Take a picture of the wiring**

Take a picture of your existing wall plate's wiring and save it for reference. Make sure you can read the wire terminal labels.

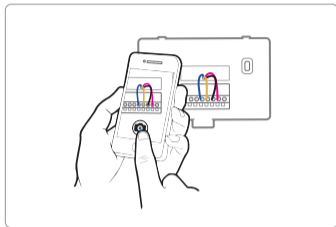

Step 5 **Label the wires**

Label the old wall plate wires with labels from our new thermostat box.

NOTE: If there's an Rc or Rh wire, attach the R label to it.

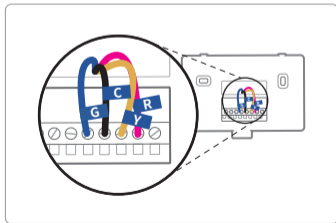

Step 6

Disconnect the wires and remove the old wall plate

Disconnect the wires from the old thermostat one by one, you may need a screwdriver to release wires from terminals.

NOTE : Wrap the wires around a pen or pencil so they don't fall back into the hole in the wall.

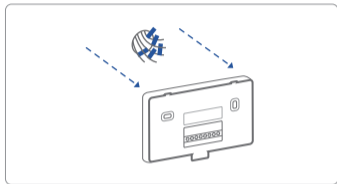







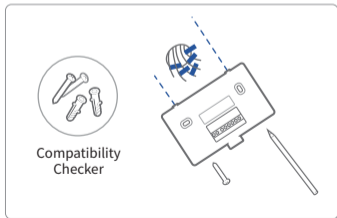

Step 7

Mount the New Wall Plate

Use the screw set (screw & anchor) to mount the new wall plate. In most cases, the old mounting position can be used; if not, apply the new set. Be sure to check the alignment of the new wall plate before and after the wall plate installation.



Use the picture you took before as reference to wire, the following chart is a wiring diagram for common systems, please make sure that a C-wire exists in your old thermostat system.

Terminal		Conventional System	Heat Pump System
RC		Power for cooling, 24V	Power for cooling, 24V
RH		Power for heating, 24V	Power for heating, 24V
C		Common wire, 24V	Common wire, 24V
G		Fan	Fan
Y		1st Stage Cool	1st outdoor Stage Heat
Y2		2nd Stage Cool	2nd outdoor Stage Heat
W/E		1st Stage Heat	1st Stage Auxiliary/Emergency Heat
O/B/W2		2nd Stage Heat	Changeover (reversing valve) connection for heat pump

Single Stage Heat / Two Stage Heat- Furnace / Boiler with C-wire

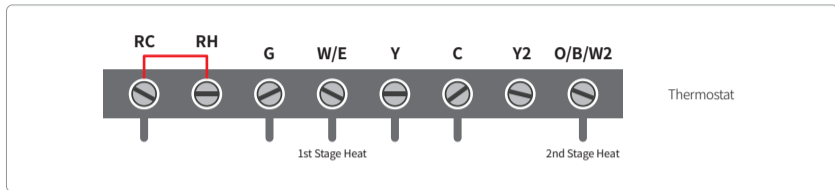

Combined Single Stage Heat and Single Cool Stage with C-wire

(Remove Pre-installed Jumper)

Cool Furnace and Air Conditioner

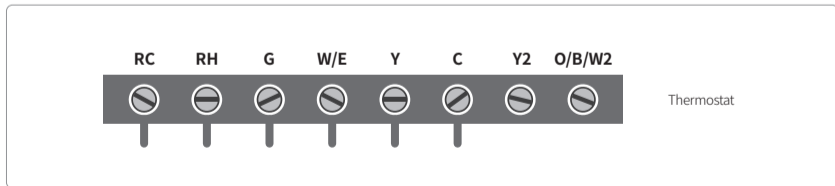

Single Stage / Two Stage Heat Pump with Emergency Heat and Auxiliary Heat with C-wire

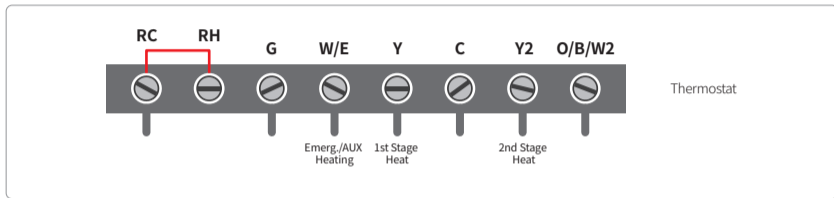

Single Stage Cool / Two Stage Cool-Air conditioner

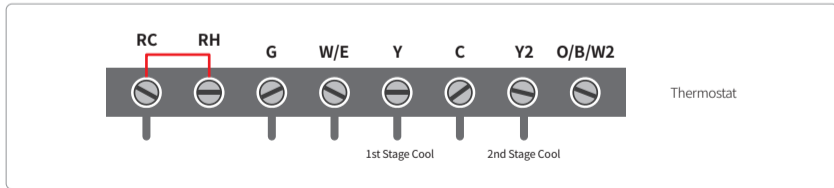

Dual Fuel System-Combined Single Stage Heat Pump and Single Stage Furnace with C-wire

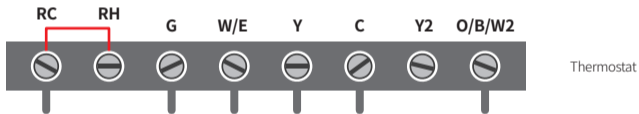

If C-wire does not exist in your system, check the instruction below:

Do you have a spare wire? Yes.

1. Check for the spare wire behind your wall plate or old thermostat, if there's one, connect it to the C-terminal of the new wall plate.
2. Remove the cover of the furnace or heating system, open the cover of the heating/cooling system to find the control board where you should find the same terminal labels as of the thermostat.
3. Find the other end of the spare wire, locate the bundle of wire with the same labels as that of your thermostat end.
4. Connect the spare wire to the C-terminal.
5. Close the cover of the furnace or heating system.

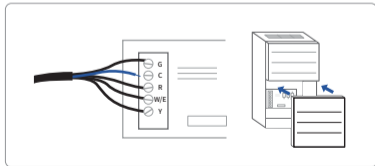
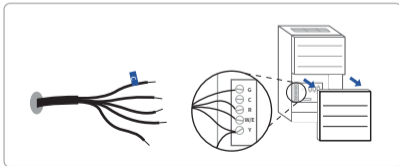

Step 8**Connect the wires to the new wall plate**

Refer to the above wiring diagram, insert all wires vertically from the open socket into the proper terminal. Ensure each wire is inserted into the matching terminal (refer to the photo taken previously if needed). Pull wires gently to ensure wires are securely fastened.

When all wires are connected well, place excess part of the wires back to the wall.

**Step 9****Install the thermostat to the wall plate**

First aim the two clips in upper part of the thermostat to the top of the wall plate, then gently push and fit the wiring pole to the terminals on the wall plate.

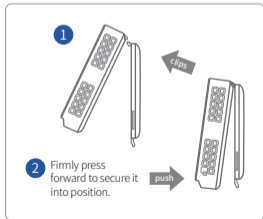

Step 10

Power on and Enjoy

Turn on the switch that controls your heating and cooling system, the thermostat will be powered on and prompt you to start the setup. If you have any trouble installing the device or app, check the below information for help, or simply visit our websites for installation videos.

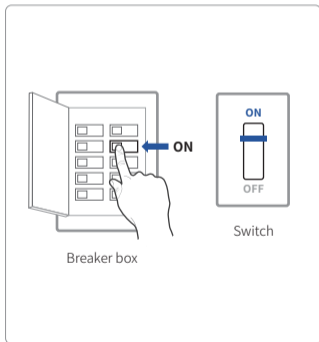

WE ARE HERE TO HELP, 24/7 !

WEBSITE : www.vineconnected.com

EMAIL : support@vineconnected.com

HOTLINE: 1-800-264-3457(09:00am~05:00pm

MON~FRI PST)

Initial Setup

Step 1

Device Initial Setup

For a quick and easy way to begin using your new smart thermostat, the device will automatically direct you to the Initialization Setup process once it's turned on for the first time.

- 1 Equipment Type**
Select your home's heating equipment type from the options available:

Gas/Oil/Furnace, Electric, Heat Pump, Dual Fuel or no Heating. Select according to your heating system.

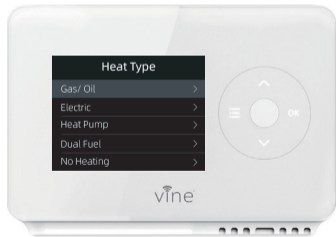

Below is a list of possible examples which may help you to select correctly:

NOTE: If you are unsure of which option to select, contact 1-800-264-3457

If you have a **furnace or boiler:**

1. Select Gas/Oil/Furnace.
2. Touch OK button to continue.
3. Tap "Next" at the bottom of the screen to continue.



If you have a **heat pump:**

1. Select Heat Pump and touch OK to next step.
2. Specify what the heat Pump runs when the O/B Reversing Valve is engaged: On Cool runs cooling when O/B engages, Or On Heat runs he runs heating when O/B engages.
3. Tap OK to continue.



If you have a **Dual fuel system:**

1. Select Dual Fuel and tap OK.
2. Then follow the on-screen instructions to configure the fossil fuel heating appliance settings,
3. Click Next at the bottom of the screen to continue to configure the heat pump heating appliance settings.



2 Date & Time

ON DEVICE: Follow the screen instruction to set date and time of thermostat; once the device is registered or linked to a user account, the date and time on the device will be updated automatically to the current time with the user account.



3 Schedule

Select the schedule you would like to run in your thermostat. Only 2 schedules (Home & Vacation) will be available during offline operation. However, there are 4 schedules when a Wi-Fi connection is established.



4 Wi-Fi Setup

A reliable Wi-Fi connection is required in order to access smart features such as remote access, weather forecast and more. Please follow on-screen instructions to complete the Wi-Fi setup.

ADD DEVICE

a. After signing into your account, click the plus(+) in the top right-hand corner to add new device, click the device you like to add, if your thermostat model is TJ-225, please tap TJ-225 button to add it. if it is TJ-225B please tap TJ-225B button.



- b. Return to your thermostat to select the “Set by your phone” to start Wi-Fi setup.
- c. Return to your app, and follow the on-screen instructions to connect the TJ-225 Thermostat to your Home’s Wi-Fi network, tap "Connected to Wi-Fi" to go on. Then enter your home Wi-Fi password.



NOTE: If you skip this step, you will be required to have the Wi-Fi connection by steps: Menu->Wi-Fi->Connected ->Set by Phone and follow the instruction on screen to finish the Wi-Fi connection step.

Step 2

Add Device to your Account

Mobile App, you will be asked to enter the MAC-ID and the Temporary Verification Code.



The Temporary Verification Code (TVC) is a 4-digit code randomly generated each time you enter this screen, it expires after 180 seconds (3 minutes). Tap the Temporary Verification Code to generate a new one if it expires.

Tap the Temporary Verification Code to generate a new one if the previous code expires.



Main Screen

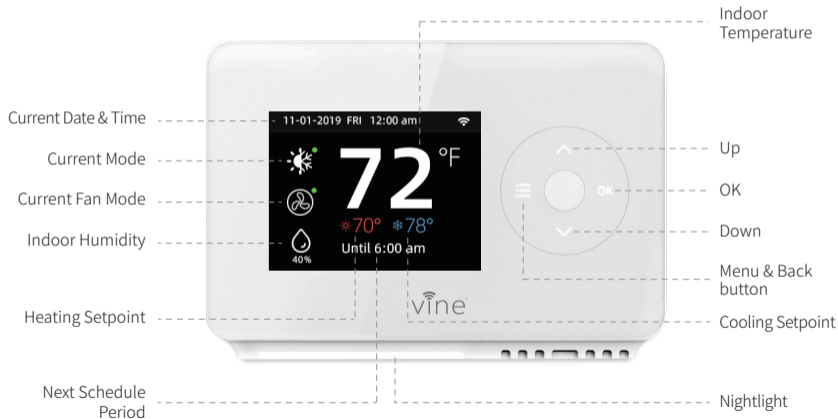

Mode Setup

The HVAC system settings depends on the type of system you use, common options are shown below:



Cool

Turn on cooling when the current temperature rises above the setpoint.



Heat

Turn on heating when the current temperature drops below the setpoint.



Auto

Activate the heating or cooling system as required to keep your home within the configured range of setpoint.



EM. Heat

Use only the Emergency Heat or backup heat source to maintain the heat setpoint. This option only appears if Emergency heat is configured in the Equipment menu.



Off

Turn the system off. When the system is off, only the current temperature will be displayed on the Home screen.

On Thermostat :

Select Main Menu > System, use the “ ^ ” and “ v ” to change the system mode of your thermostat between : Cool, Heat, Auto, Emergency Heat or Off.

Emergency Heat (Em Heat) mode is only available if you have selected Heat Pump as your Heat Type and enabled the Emergency Heat function in the setup menu.



Fan Setup

The Fan menu displays the current furnace fan setting. Depending on your system, one or more of the following options are shown:

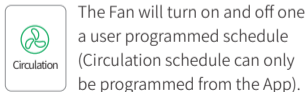
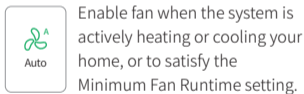
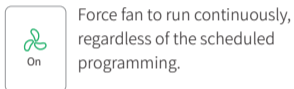

On Thermostat :

Select Main Menu > Fan, tap the “^” and “v” to change the fan mode of your thermostat between: On, Auto or Circulation.



Adjusting the Temperature :

You can override the scheduled temperature by tapping the “ ^ ” and “ ∨ ” to change the blue number represents the cool setpoint; the red number represents the heat setpoint. When the thermostat is in Auto mode, you must first select either your heating or cooling setpoint depending on which setpoint you would like to modify.

NOTE : You can override the current program by tapping the Arrow to adjust the temperature. It will be temporary setting, meaning that the override expires when the next scheduled program begins.

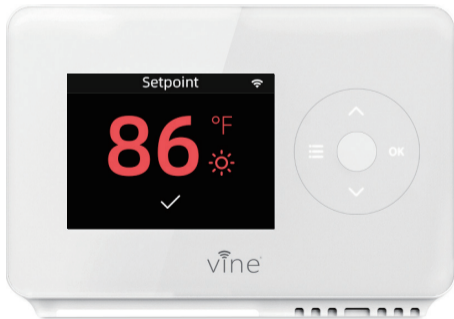

Schedule :

Tap the “^” and “v”. to change the active schedule or select No schedule.

NOTE : There are only two default programs available for selection, please follow instructions on App to create new programs.



Wi-Fi Settings

Your Thermostat supports 2.4G Wi-Fi 802.11 b/g/n. Wi-Fi is normally configured during initial setup. You may be required to reconfigure the settings if your Wi-Fi network settings change.

1. Wi-Fi Connect

Use the up and down arrow to Connect, Reconnect or Disconnect from your home's Wi-Fi Network.

2. Connect

Follow the instruction to connect the Wi-Fi with your phone.

On Thermostat:

Select Main Menu > Wi-Fi > Connect
Connect.



Advanced Setting:

To access the Equipment Setup, click on a setting and use the scroll wheel to modify the default value by following steps: Menu- Setting- Advanced setting.

Terminal	Default	Max	Min	Description
Deadband	1° F	2° F	0.5° F	A temperature range between the current temperature and the heating setpoint, where heating or cooling is not engaged.
Fan Delay	60s	120s	30s	The time fan continues after mode turn off.
Min Run time	180s	300s	60s	The min. time system on after engaging.
Cycle time	180s	300s	60s	Waiting time between heating and cooling.
Runtime	/	/	/	View system runtime, Heating, Cooling, Air Filter.
Sensor Calibration	0° F	10° F	-10° F	Ability to adjust temperature readings to improve sensor accuracy as the thermostat nears the end of its lifecycle after years of use.

Main Screen



Programming your Schedule Adjusting Schedule

1. To add a new Schedule, click the plus (+) in the top right-hand corner, name your schedule and click OK.
2. To modify an existing Schedule, select a Schedule from the list it will change to programming screen.
3. If you want to delete an Existing Schedule, select the schedule and swipe left, select Delete.

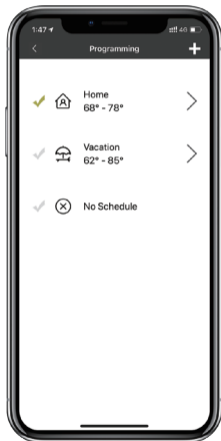

Setting a period

1. Touch the day of the week you want to adjust.
2. Select an existing period activity to edit.
3. You can also create a new activity by touching +.
4. Select Start time, Heat setpoint and Cool setpoint. Swipe to select the new time value.
5. Touch Save

Note: You can only select time values that are at least 15 min after the previous activity to 15 min before the next scheduled activity

Delete an Existing Period

1. Tap the period you want to delete, click  to delete the period.

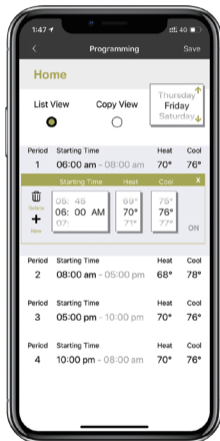

Copy a Schedule

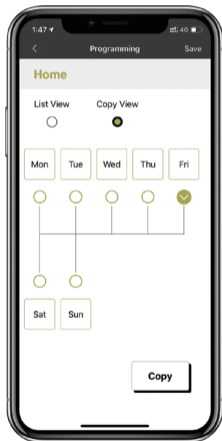

To copy the entire schedule from one day to another day (for example, if all your week days follow the same schedule) :

1. Click Copy View
2. Select the days that will use the copied schedule (you can select more than one).
3. Select Copy

Icon Reference

List View	View the program in List View.
Copy View	Copy the setpoints to other days of the week.
ON / OFF	Select desired temperature or system off for the period.
New	Inserts a new period before the current one.
Delete	Deletes the current period, merging the time with the next period.

Advanced Features

Except from the afore-mentioned basic settings, Vine Smart Wi-Fi Thermostat also provide possibility to connect to the Alexa and Google Assistant, hence control your room temperature through a simple voice comes true. Follow our instructions below to get connected with Alexa/Google.

How to connect to Alexa?

1. Download and register the thermostat as instructed in page 1 ~ 39.
2. Download Amazon Alexa app and set up your Alexa-enabled device.
3. Tap "Menu" button on the upper left corner of Alexa app main screen.
4. IMPORTANT step - link Skill.
 - 1 Tap "Skills" in Alexa app menu.
 - 2 Type and search "Vine Control", then choose and tap "enable" to enable the skill.
 - 3 Enter ... Control account to Alexa Skill.

Now you can control your thermostat over Amazon Alexa.



5. Common commands

Common commands for Alexa to control Vine Thermostat:

Alexa, turn (Device Name) on.

Alexa, turn (Device Name) off.

Alexa, Change (Device Name) Mode to Cool/Heat/Auto.

Alexa, Increase (Device Name) by __ degrees.

Alexa, Decrease (Device Name) by __ degrees.

Alexa, Set (Device Name) to __ degrees.

Alexa, what is the (Device Name) set to?

Alexa, what is the temperature of the (Device Name)?

How to connect to Google Assistant?

- 1 . Download and register the thermostat as instructed in page 1 ~ 39.
 - 2 . Download Google Home app and set up your Google-enabled device.
 - 3 . Tap "+" button in the middle of the Google Home app screen.
 - 4 . IMPORTANT step - link Action.
-
- ① Tap the sidebar menu on the upper left corner of the main page of Google Home, select "Home Control".
 - ② Tap the "+" button on the lower right corner and search for "Vine Control"
 - ③ Top open "Vine Control" and select country, then enter app account/password and tap "Link Now" to link your Vine account to Google.
 - ④ Enter ... Control account to Alexa Skill.

Now you can control your thermostat over Google Home.

5. Control your smart device with Google Home

Common commands for Google Home to control Vine Thermostat:

Hey Google, what's the __ temperature?

Hey Google, make it warmer (or cooler)

Ok Google, set the temperature to __ degrees

Ok Google, raise (or lower) the temperature __ degrees

“Ok Google, what is the current temperature in the Bedroom?”

“Hey Google, what's the Living Room set to?”

“Ok Google, what's the temperature of my thermostat?”

“Ok Google, turn on heat mode in the Bedroom”

“Hey Google, change to automatic mode in the Living Room”

“Ok Google, turn on cool mode in the Bedroom”

NOTE: Google Home currently supports only English Commands.

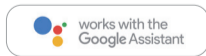

Limited Warranty

THIS DOCUMENT CONSISTS OF IMPORTANT LIMITED WARRANTY INFORMATION REGARDING YOUR CLAIMS AND ACCOUNTABILITY, AS WELL AS RESTRICTIONS AND EXCLUSIONS THAT MAY APPLY TO YOU.

1. WHAT THIS LIMITED WARRANTY ENTAILS; DURATION OF COVERAGE

VINE CONNECTED, Pleasanton, California USA, warrants to the owner of the enclosed product that the product contained in this box will be free from defects in materials and workmanship for a period of two years from the date of delivery following the original retail purchase. If the Product fails to conform to this Limited Warranty during the Warranty Period, VINE CONNECTED will, at its sole discretion, either (a) repair or replace any defective Product or component; or (b) accept the return of the Product and refund the money actually paid by the original purchaser for the Product. Repair or replacement may be made with a new or refurbished product or components, at VINE CONNECTED's sole discretion. If the Product or a component incorporated within it is no longer available, VINE CONNECTED may, at its sole discretion, replace the Product with a similar product of similar function. This is your sole and exclusive remedy for breach of this Limited Warranty. Any Product that has either been repaired or replaced under this Limited Warranty will be covered by the terms of this Limited Warranty for the longer of (a) ninety days from the date of delivery of the repaired Product or replacement Product, or (b) the remaining Warranty Period. This Limited Warranty is transferable from the original purchaser to subsequent owners, but the Warranty Period will not be extended in duration or expanded in coverage for any such transfer.

2. TOTAL SATISFACTION RETURN POLICY

If you are the original purchaser of the Product and you are not satisfied with this Product for any reason, you may return it in its original condition within thirty days of the original purchase and receive a full refund.

3. WARRANTY TERMS;

HOW TO RECEIVE SERVICE IF YOU WANT TO CLAIM UNDER THIS LIMITED WARRANTY

Before making a claim under this Limited Warranty, the owner of the Product must (a) notify VINE CONNECTED of the intention to claim by visiting vineconnected.com/support during the Warranty Period and providing a description of the alleged failure, and (b) comply with VINE CONNECTED' return shipping instructions. VINE CONNECTED will have no warranty obligations with respect to a returned Product if it determines, in its reasonable discretion after examination of the returned Product, that the Product is an Ineligible Product (defined below). VINE CONNECTED will bear all costs of return shipping to owner and will reimburse any shipping costs incurred by the owner, except with respect to any Ineligible Product, for which owner will bear all shipping costs.

4. WHAT THIS LIMITED WARRANTY DOES NOT COVER

This Limited Warranty does not cover the following (collectively "Ineligible Products"): (i) Products marked as "sample" or "Not for Sale", or sold "AS IS"; (ii) Products that have been subject to: (a) modifications, alterations, tampering, or improper maintenance or repairs; (b) handling, storage, installation, testing, or use not in accordance with the User's Guide or other instructions provided by VINE CONNECTED; (c) abuse or misuse of the Product; (d) breakdowns, fluctuations, or interruptions in electric power or the telecommunications network; or (e) Acts of God, including but not limited to lightning, flood, tornado, earthquake, or hurricane; or (iii) any non-VINE CONNECTED branded hardware products, even if packaged or sold with VINE CONNECTED hardware. This Limited Warranty does not cover consumable parts, including batteries, unless damage is due to defects in materials or workmanship of the Product, or software (even if packaged or sold with the product). VINE CONNECTED recommends that you use only authorized service providers for maintenance or repair. Unauthorized use of the Product or software can impair the Product's performance and may invalidate this Limited Warranty.

5. DISCLAIMER OF WARRANTIES

EXCEPT AS STATED ABOVE IN THIS LIMITED WARRANTY, AND TO THE MAXIMUM EXTENT PERMITTED BY APPLICABLE LAW, VINE CONNECTED DISCLAIMS ALL EXPRESS, IMPLIED, AND STATUTORY WARRANTIES AND CONDITIONS WITH RESPECT TO THE PRODUCT, INCLUDING THE IMPLIED WARRANTIES OF MERCHANTABILITY AND FITNESS FOR A PARTICULAR PURPOSE. TO THE MAXIMUM EXTENT PERMITTED BY APPLICABLE LAW, VINE CONNECTED ALSO LIMITS THE DURATION OF ANY APPLICABLE IMPLIED WARRANTIES OR CONDITIONS TO THE DURATION OF THIS LIMITED WARRANTY.

6. LIMITATION OF DAMAGES

IN ADDITION TO THE ABOVE WARRANTY DISCLAIMERS, IN NO EVENT WILL VINE CONNECTED BE LIABLE FOR ANY CONSEQUENTIAL, INCIDENTAL, EXEMPLARY, OR SPECIAL DAMAGES, INCLUDING ANY DAMAGES FOR LOST DATA OR LOST PROFITS, ARISING FROM OR RELATING TO THIS LIMITED WARRANTY OR THE PRODUCT, AND VINE CONNECTED' TOTAL CUMULATIVE LIABILITY ARISING FROM OR RELATED TO THIS LIMITED WARRANTY OR THE PRODUCT WILL NOT EXCEED THE AMOUNT ACTUALLY PAID FOR THE PRODUCT BY THE ORIGINAL PURCHASER.

7. LIMITATION OF LIABILITY

THE VINE CONNECTED ONLINE SERVICES ("SERVICES") PROVIDE YOU INFORMATION ("PRODUCT INFORMATION") REGARDING YOUR VINE PRODUCTS OR OTHER PERIPHERALS CONNECTED TO YOUR PRODUCTS ("PRODUCT PERIPHERALS"). THE TYPE OF PRODUCT PERIPHERALS THAT MAY BE CONNECTED TO YOUR PRODUCT MAY CHANGE FROM TIME TO TIME. WITHOUT LIMITING THE GENERALITY OF THE DISCLAIMERS ABOVE, ALL PRODUCT INFORMATION IS PROVIDED FOR YOUR CONVENIENCE, "AS IS", AND "AS AVAILABLE". VINE CONNECTED DOES NOT REPRESENT, WARRANT, OR GUARANTEE THAT PRODUCT INFORMATION WILL BE AVAILABLE, ACCURATE, OR RELIABLE OR THAT PRODUCT INFORMATION OR USE OF THE SERVICES OR PRODUCT WILL PROVIDE SAFETY IN YOUR HOME. YOU USE ALL PRODUCT INFORMATION, THE SERVICES, AND THE PRODUCT AT YOUR OWN DISCRETION AND RISK. YOU WILL BE SOLELY RESPONSIBLE FOR (AND VINE CONNECTED DISCLAIMS) ANY AND ALL LOSS, LIABILITY, OR DAMAGES, INCLUDING TO YOUR WIRING, FIXTURES, ELECTRICITY.

HOME, PRODUCT, PRODUCT PERIPHERALS, COMPUTER, MOBILE DEVICE, AND ALL OTHER ITEMS AND PETS IN YOUR HOME, RESULTING FROM YOUR USE OF THE PRODUCT INFORMATION, SERVICES, OR PRODUCT. PRODUCT INFORMATION PROVIDED BY THE SERVICES IS NOT INTENDED AS A SUBSTITUTE FOR DIRECT MEANS OF OBTAINING THE INFORMATION. FOR EXAMPLE, A NOTIFICATION PROVIDED THROUGH THE SERVICE IS NOT INTENDED AS A SUBSTITUTE FOR AUDIBLE AND VISIBLE INDICATIONS IN THE HOME AND ON THE PRODUCT, NOR FOR A THIRD-PARTY MONITORING SERVICE THAT MONITORS ALARM STATE.

8. YOUR RIGHTS AND THIS LIMITED WARRANTY

This Limited Warranty gives you specific legal rights. You may also have other legal rights that vary by state, province, or jurisdiction. Likewise, some of the limitations in this Limited Warranty may not apply in certain states, provinces or jurisdictions. The terms of this Limited Warranty will apply to the extent permitted by applicable law. For a full description of your legal rights you should refer to the laws applicable in your jurisdiction and you may wish to contact a relevant consumer advisory service. Please visit our website for the complete disclosure of this statement



www.vineconnected.com